

How to Install your 10" Non Integrated Display

*** Please note that we do not have these parts hooked up to a machine so you can see them better. We recommend you install the Butler and Display clamp to your machine before hooking up all the cables***

This is what you will receive in order to install your display.

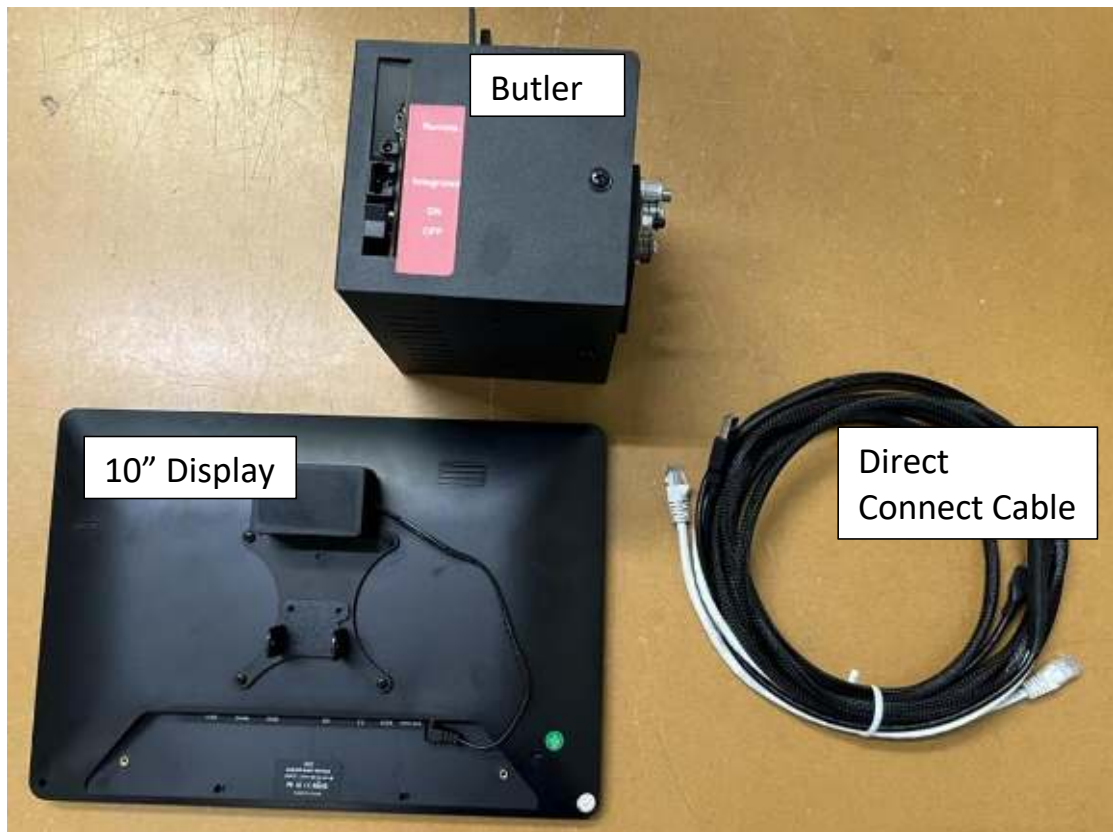

You are going to want to connect your display bracket on your display to your display bases on your display bracket that is connected to your machine. The picture below shows the display bases are in the blue rectangles.

****Some display brackets and bases are white, some are black****



Take out both of the screws



Align the holes in the display clamp with the holes in the display bases. You may need more than one person for this step.



Screw the screws back into the bracket.

You will want to make sure the screws are tight enough to hold the display. Then adjust the display to the angle you like and then finish tightening the screws.



You are going to connect the Butler with direct connect cable.

The direct connect cable has two ends that connect to different places. To connect to the Butler you want to use the end with the RJ45 (phone jack plug) and the micro USB.

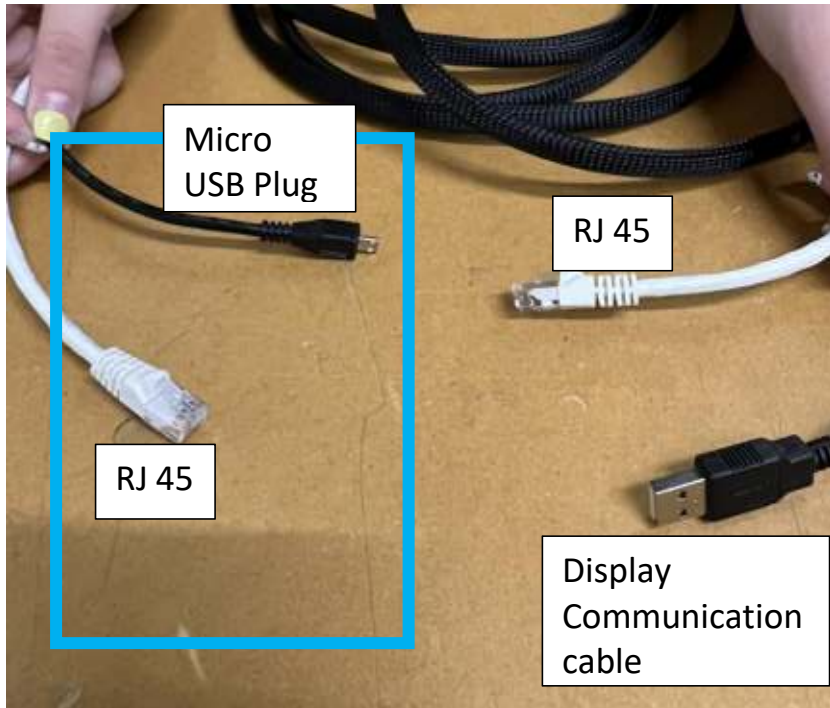

For this install you are going to be using the remote port and the integrated port.

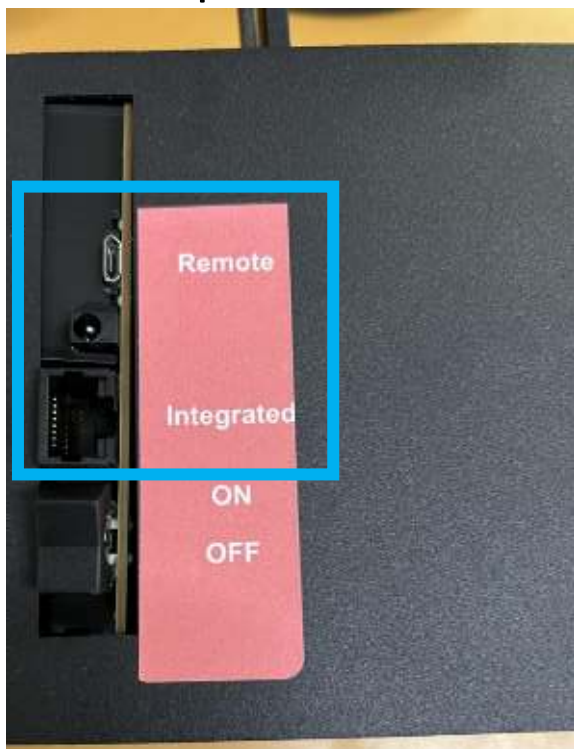

First plug in the RJ45 cable into the integrated port .

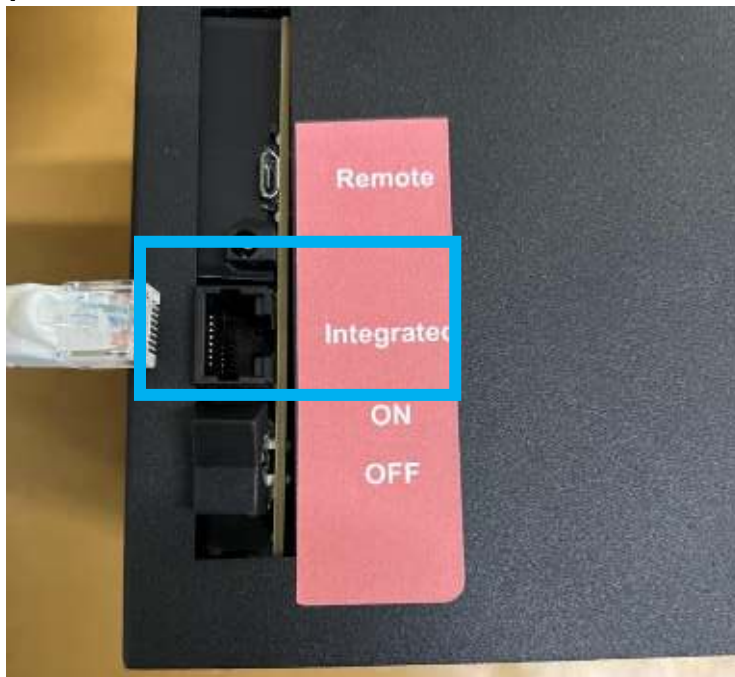

Next plug in the micro USB port into the micro USB port on the robot.

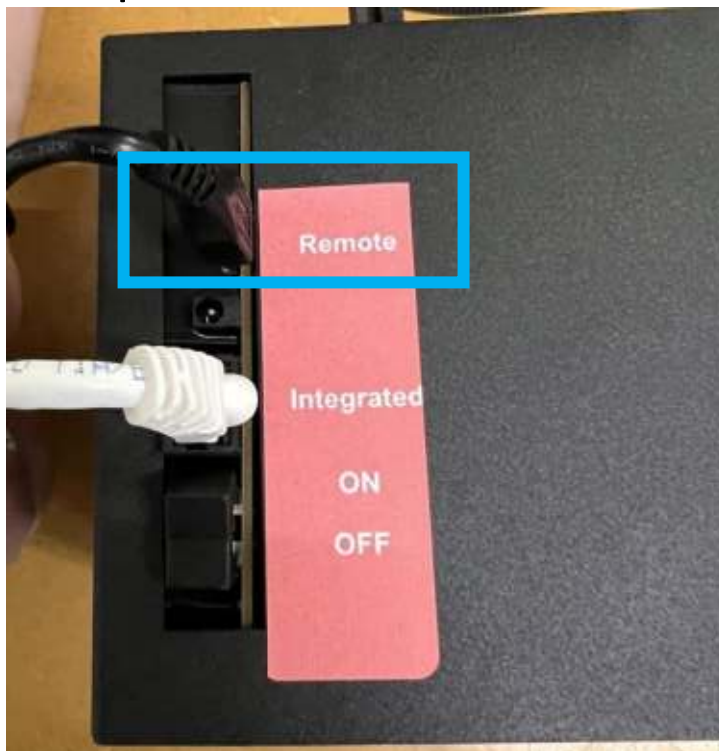

Next you are going to plug in the display side. To connect to the Display you want to use the end with the RJ45 end and the USB end.

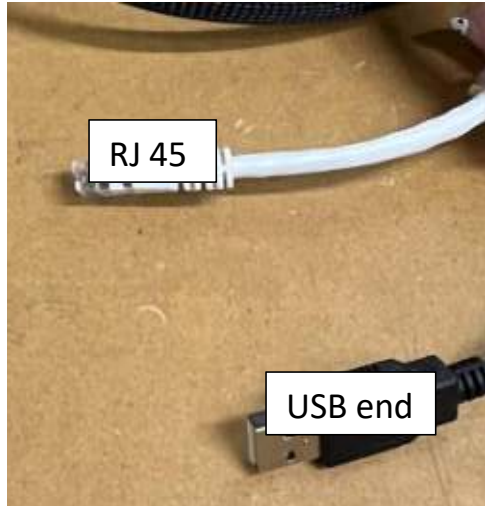

You will take the RJ45 end and plug it into the port on the translator (small black box connected to the display).

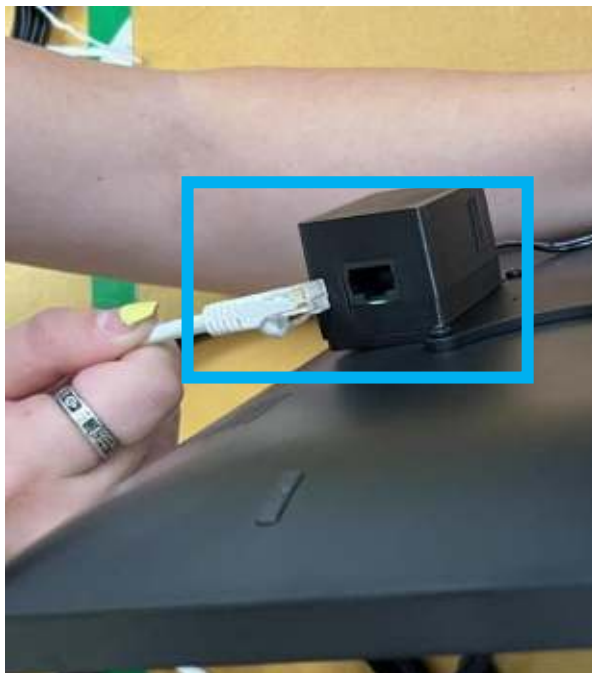

Next plug in the USB end into the USB port closest to the power plug.



You are all ready to turn on your system!
Enjoy!