

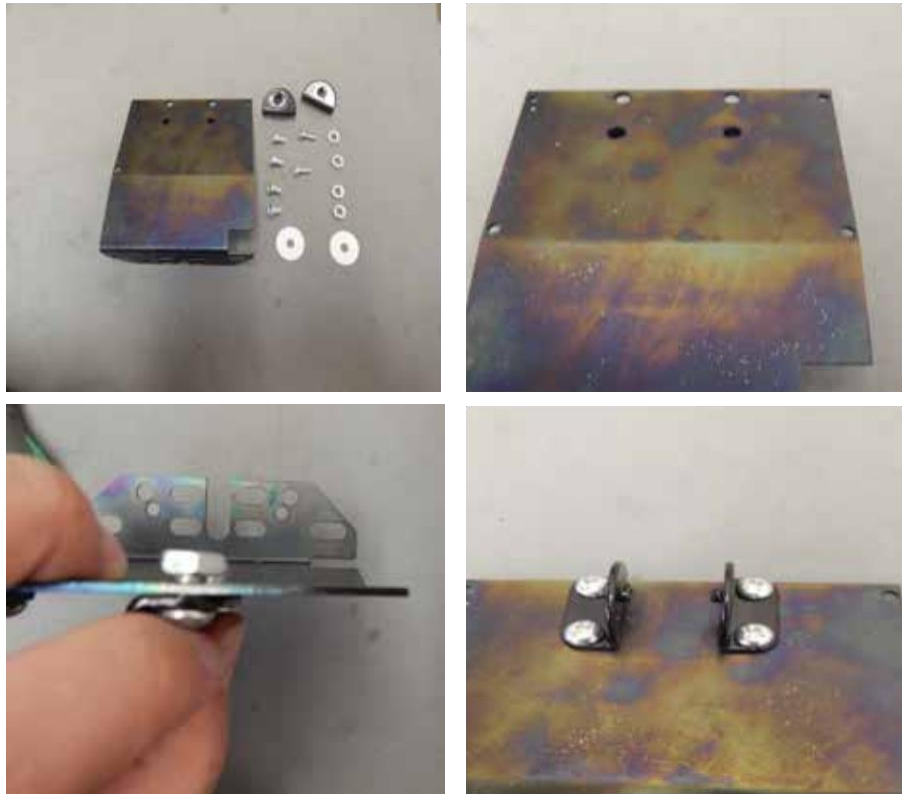

Android Installation Guide

Install Remote Bases

- 1 Use the provided M6 x 8mm screws and the M6 nuts to moun the remote bases to the display bracket with the back walls facing in.



Images used are not representative of all display brackets. Use these concepts to mount the remote bases to the provided display bracket.

Install Display

- 1 Line up display holder with the remote bases with the poly disc placed in between, and install with the provided 8-32 x .5" screws.

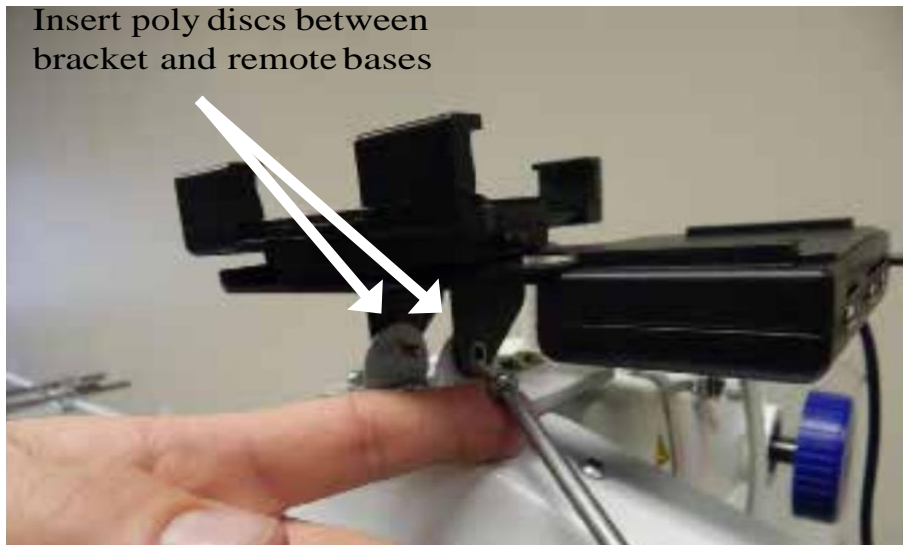

Images used are not representative of all display brackets. Use these concepts to mount the remote bases to the provided display bracket.

2 The universal bracket will fit either a 7" or 10" Android tablet.

Press the button release on the side to raise the arm.

You will not need to press the button to lower the arm. Just apply pressure down on the sliding arm.

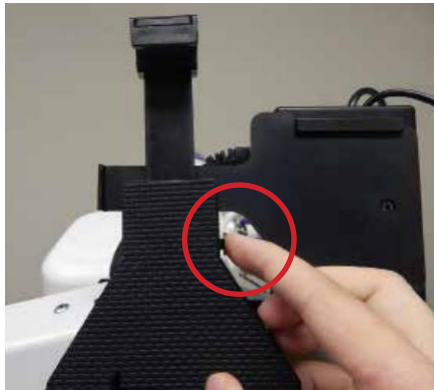
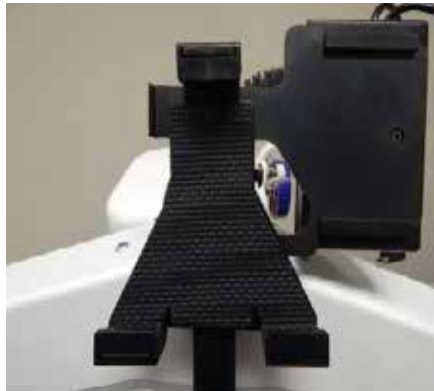

3 Position the tablet on the clamp with the camera facing up.

Press down on the arm at the top to secure the tablet.



Camera



4 Connect the cables

10" Android

Plug the circular power cable into DC IN and the micro-USB cable into Host.

The port labeled USB should be plugged on 10" models, but take note, the system will not communicate in this port.

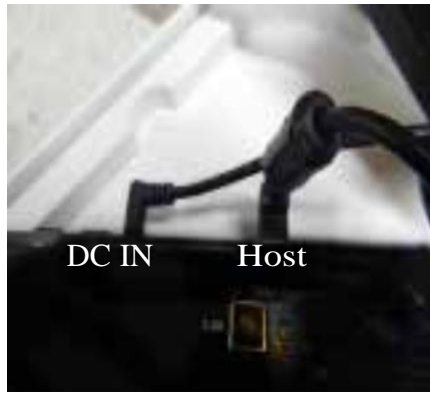

7" Android

Plug the circular power cable into DC IN and the micro-USB cable into Host/USB.



5 Locate display cable. It will be a network style cable on one or both ends.

Plug the network style end into the hub (black box mounted to the display bracket).

Follow the instruction set that represents your machine.

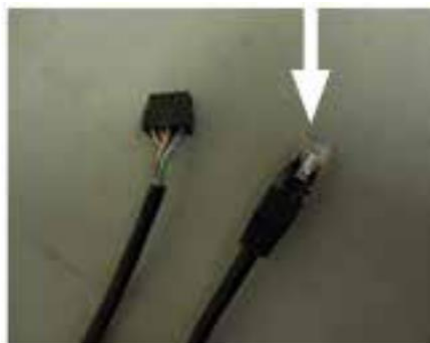

6 For Robotics Only:
Plug the ethernet end of the black cable into the Remote port on the Black Motor Box



For Machines with
QuiltEZ Electronics:
Plug the remaining end of the black cable into the port near the front of the machine.

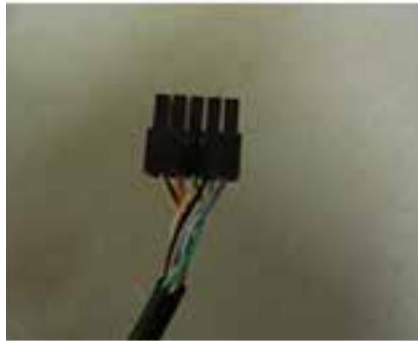

If the machine has a rocker arm cover, then this connection is inside the machine. Remove the rocker arm, and locate the joint in the cable.

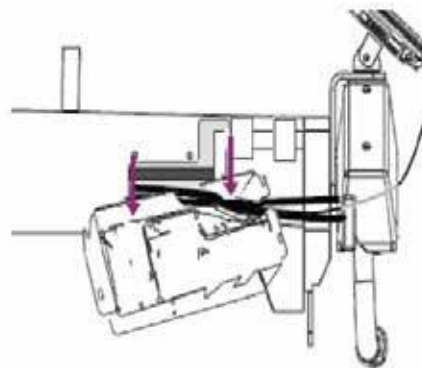

For Upgraded Machines:
Machines that have had the
Perfect Stitch upgrade.

Remove the rear PCB box, and
connect the remaining end of the
black cable into the
indicated remote port.



If possible, route the cable
internall

This guide applies to the new style of robots.

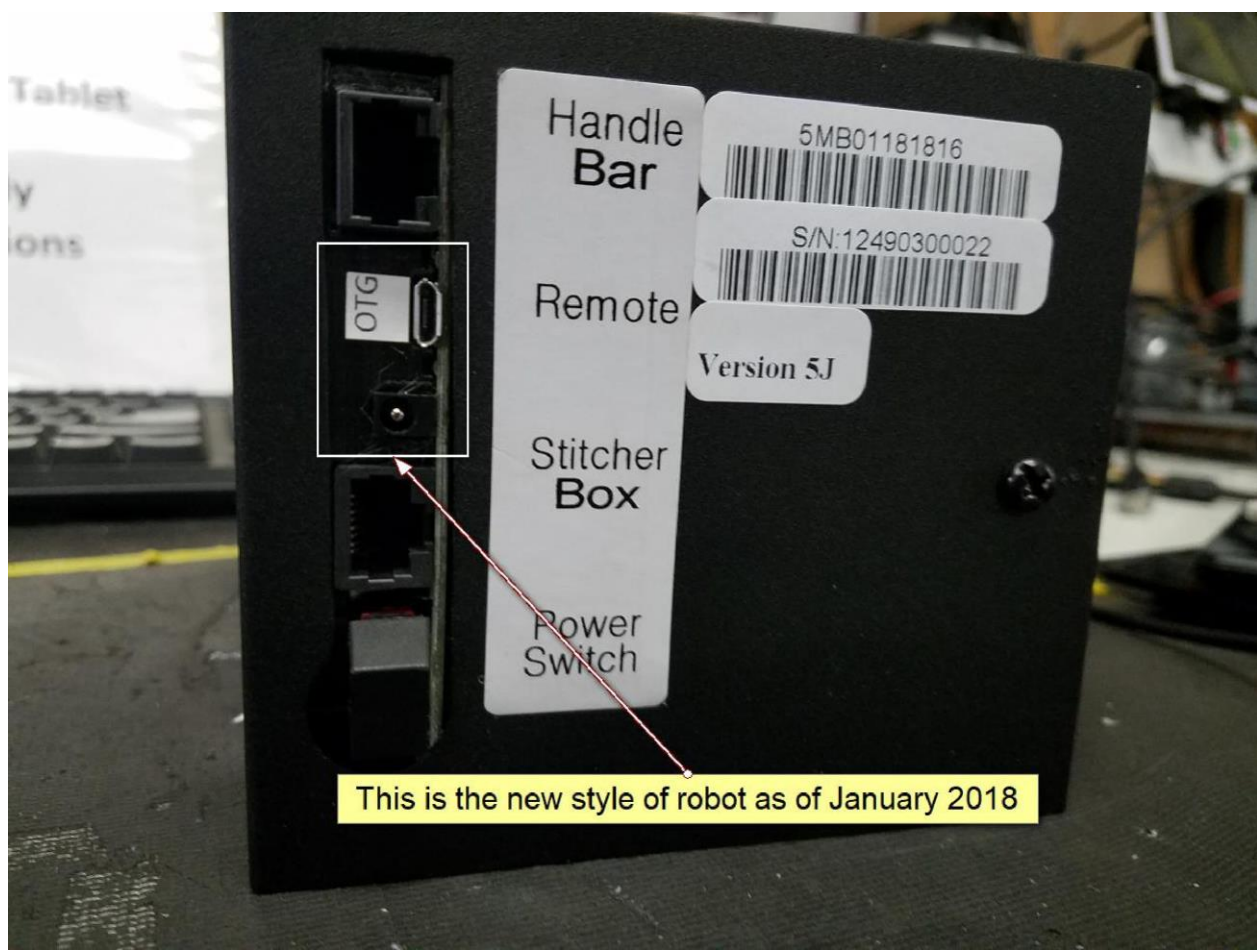

This is the new style of robot as of January 2018

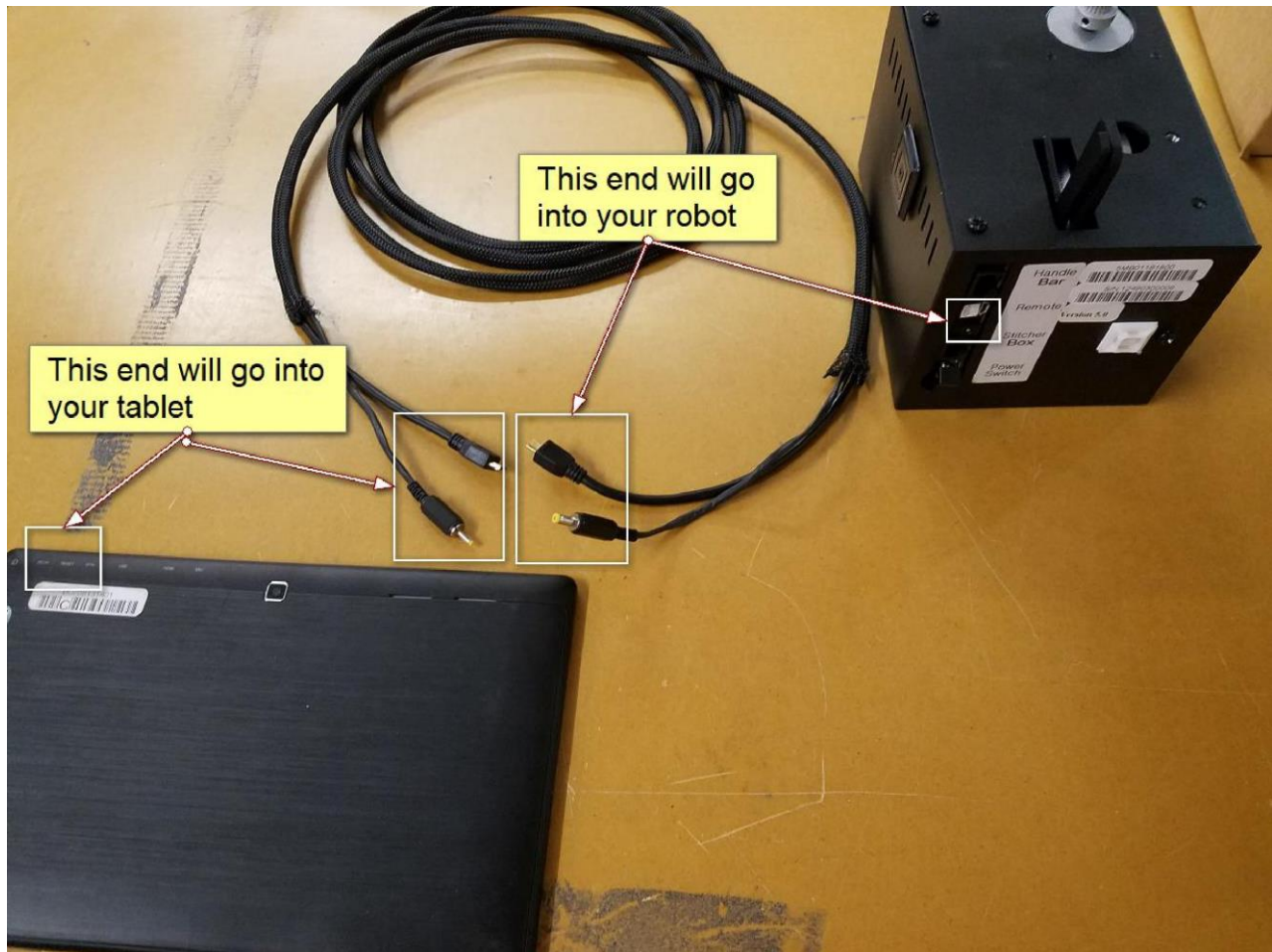
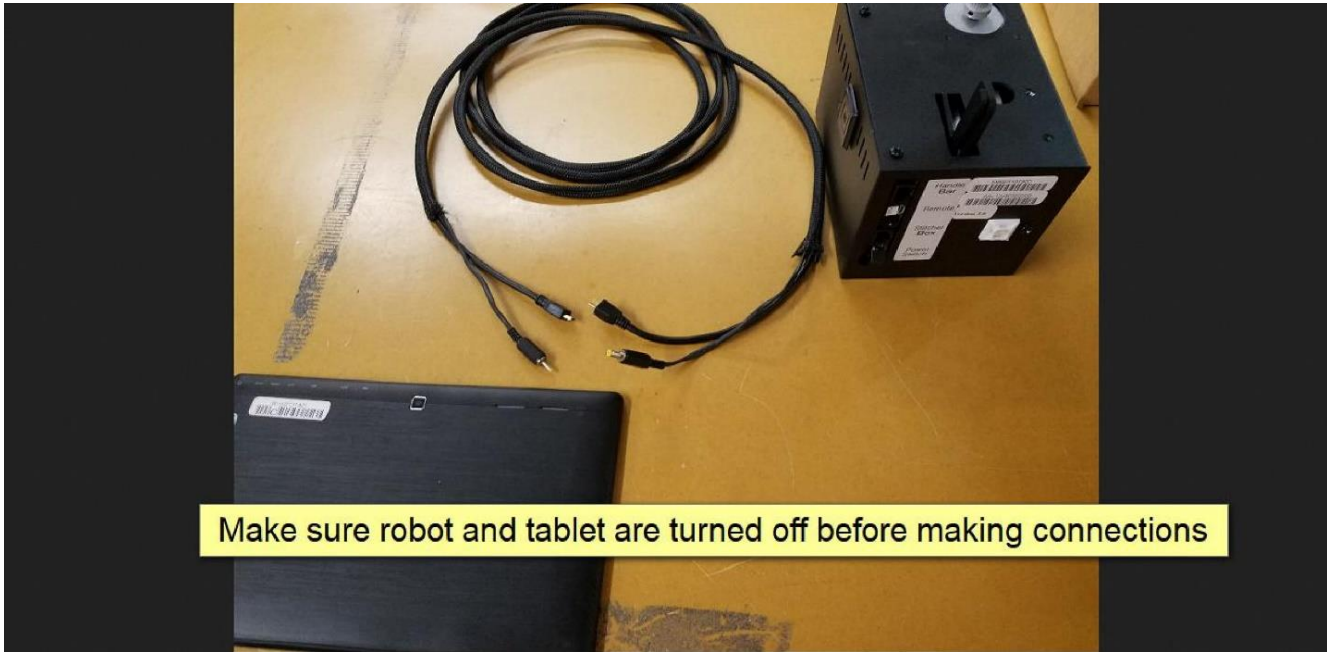

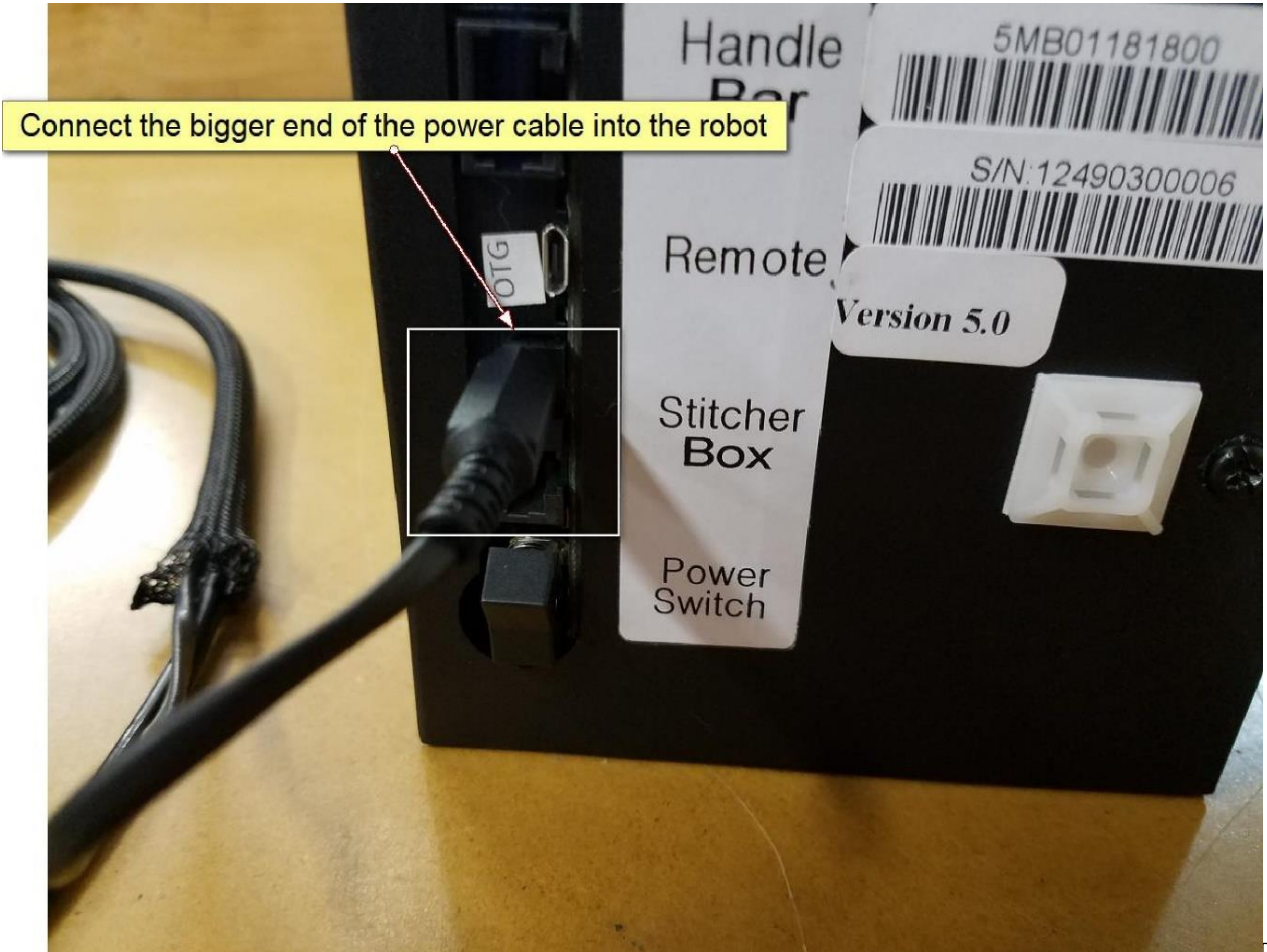
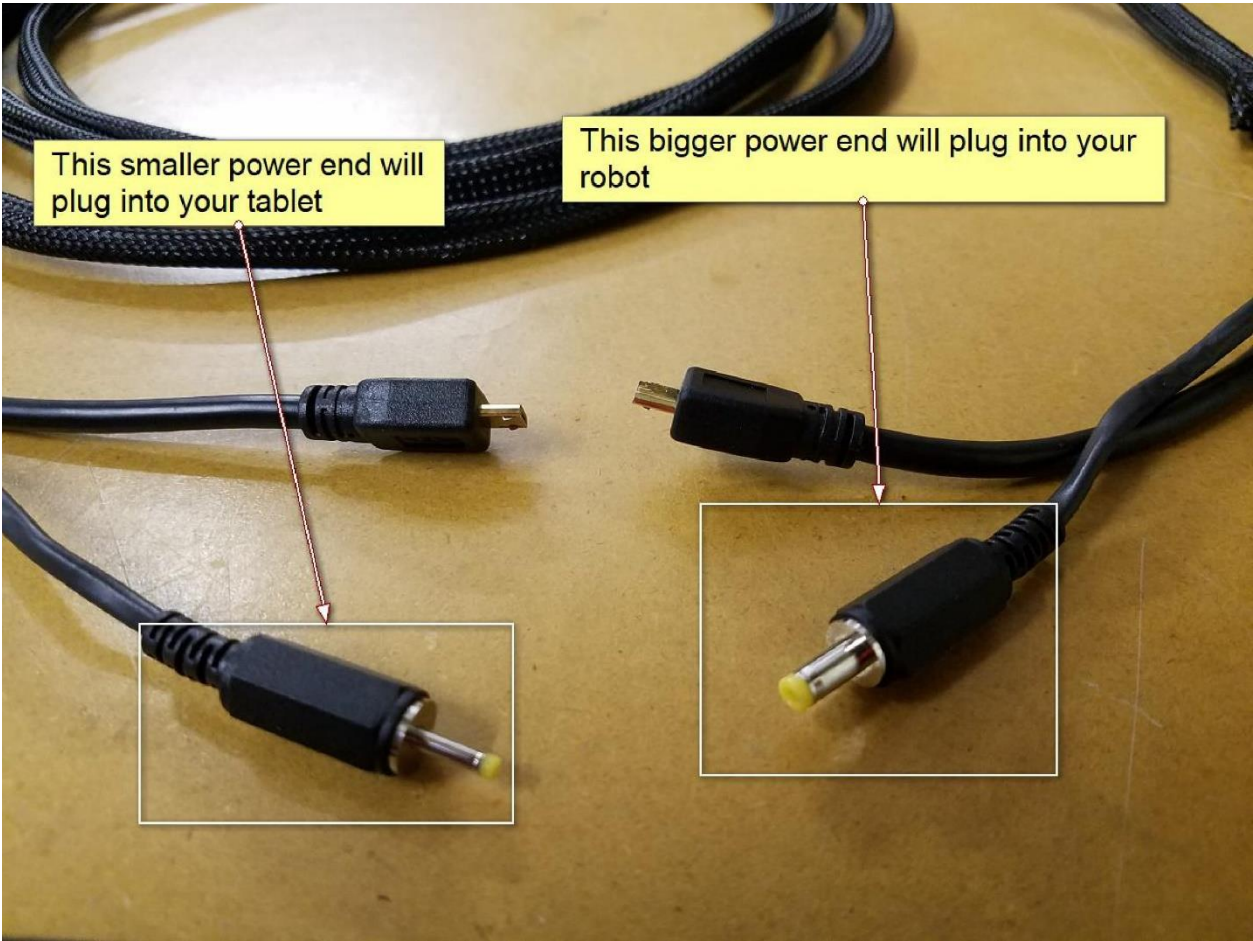

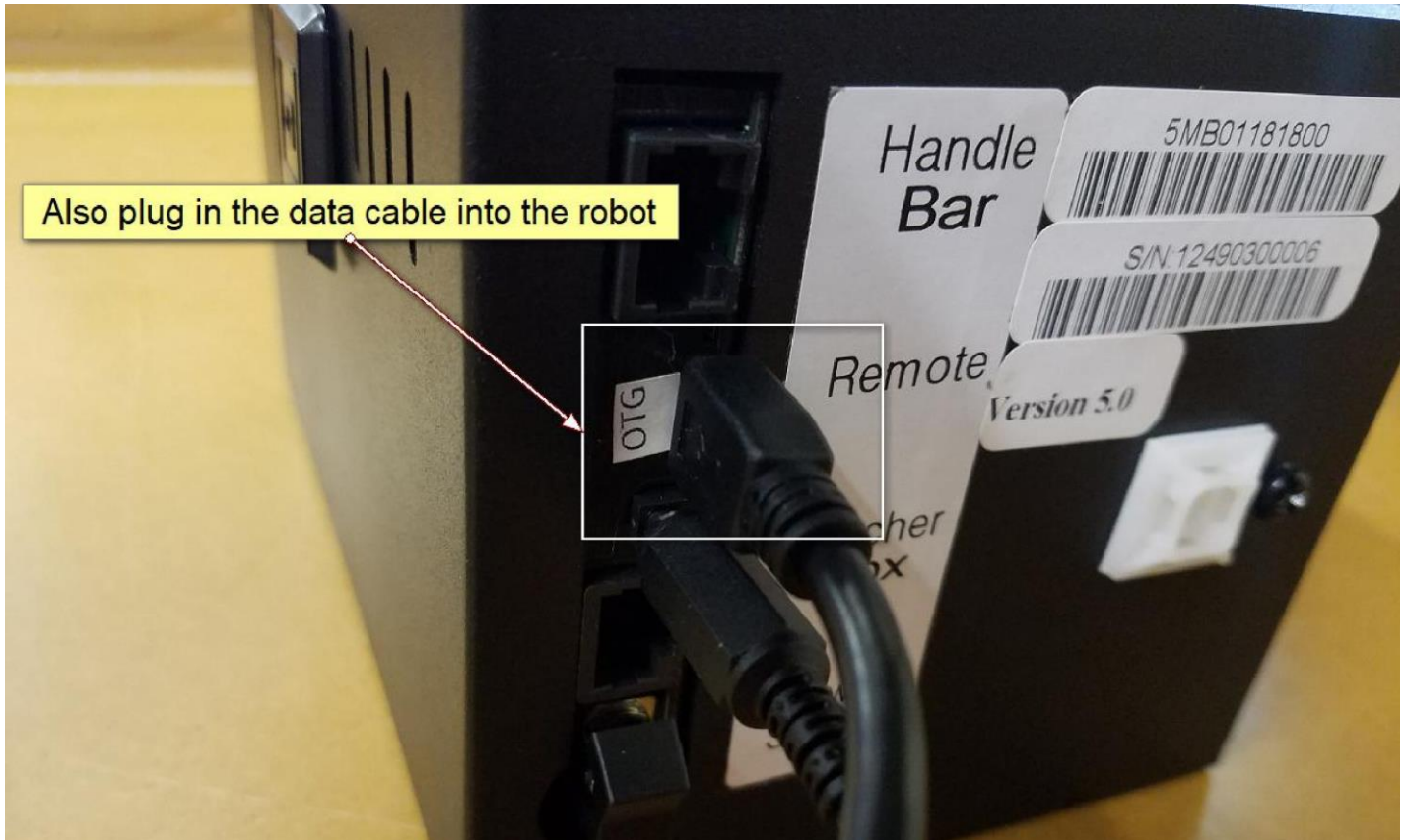

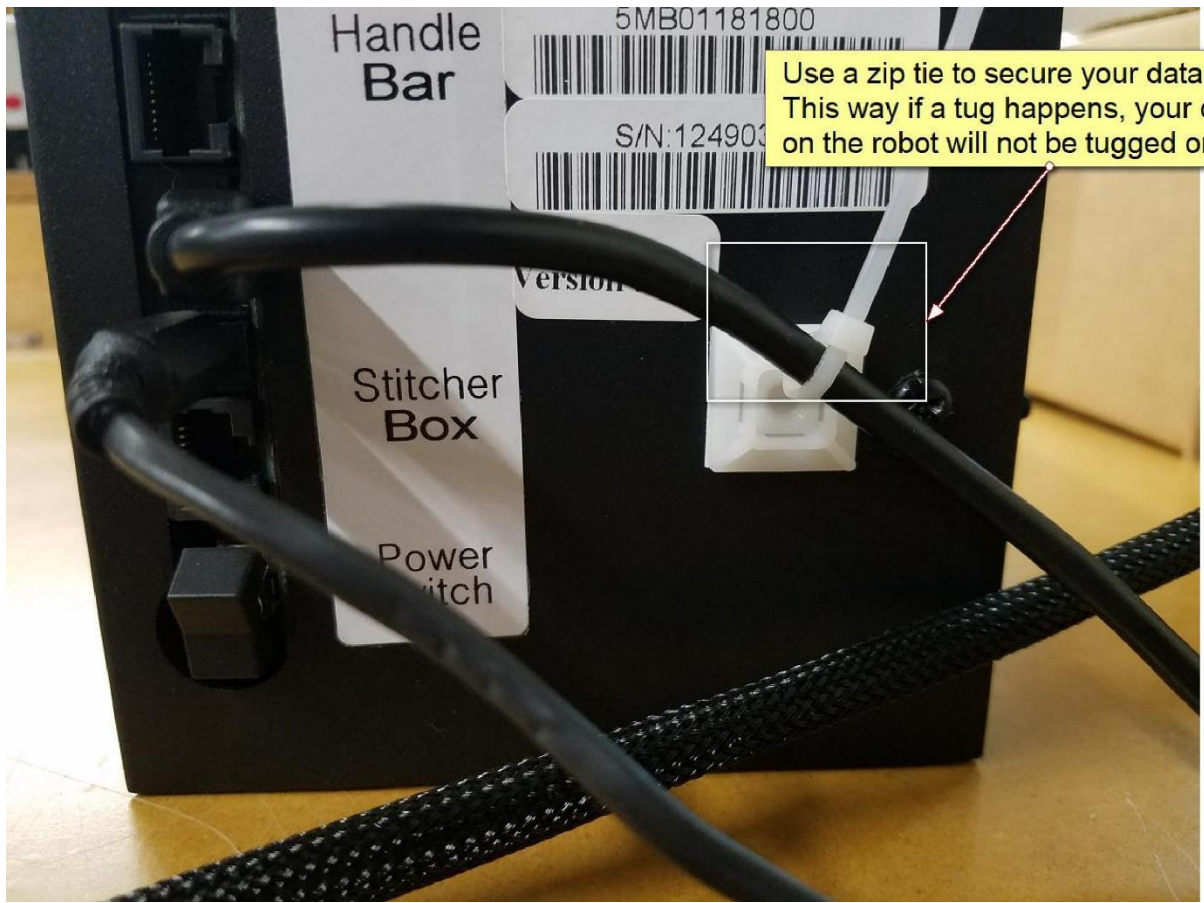

Use a zip tie to secure your data cable. This way if a tug happens, your data port on the robot will not be tugged on.

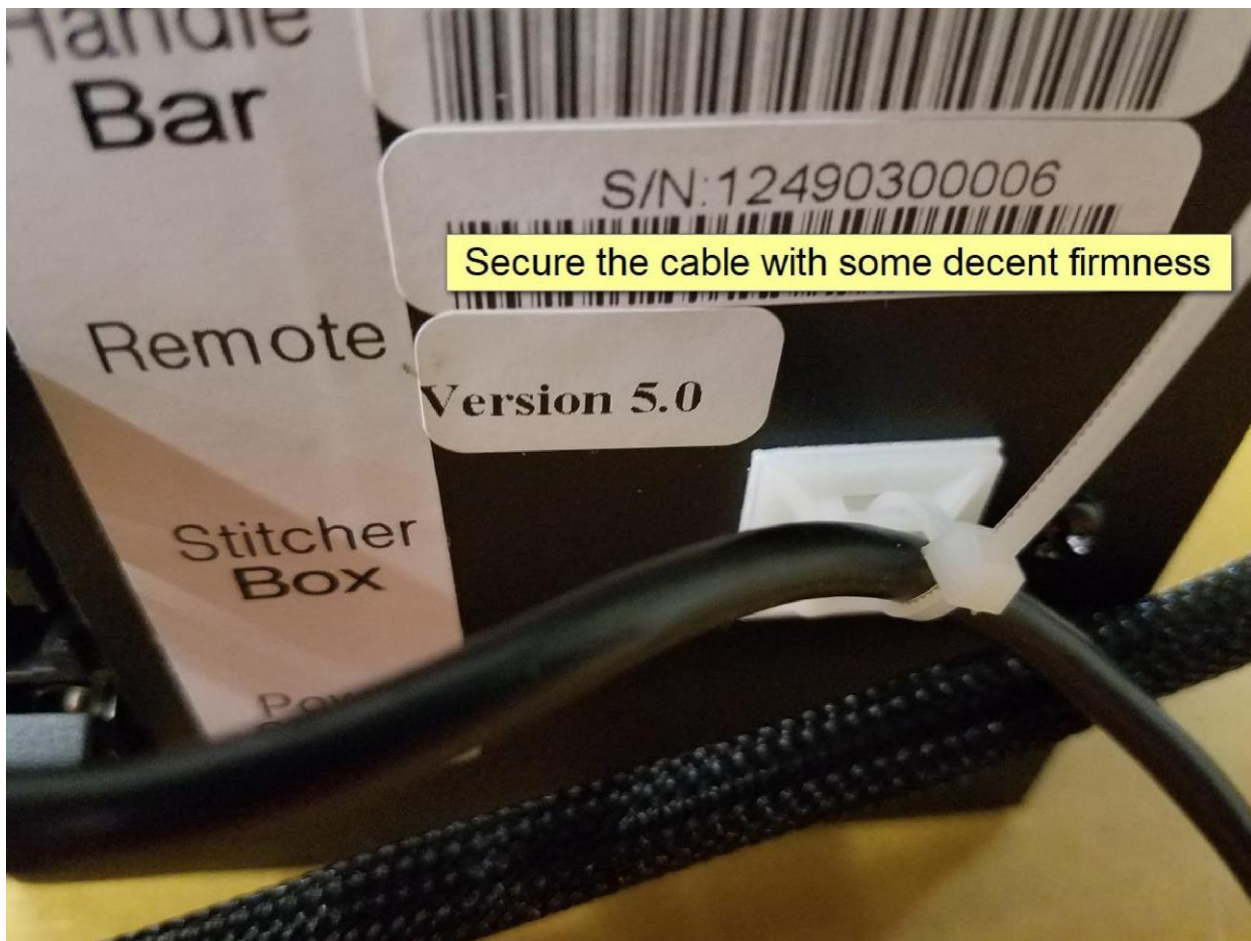

Secure the cable with some decent firmness

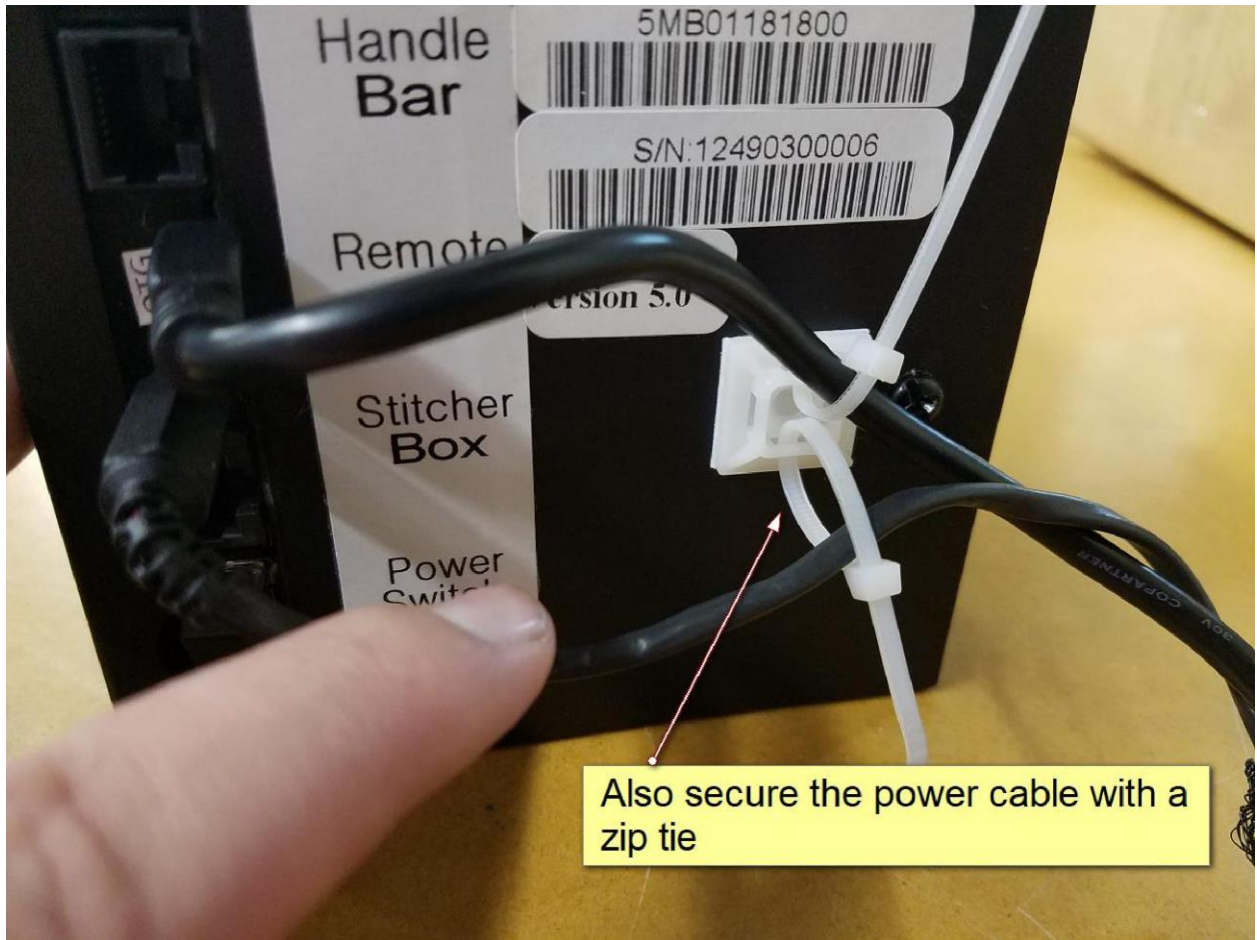

Also secure the power cable with a zip tie

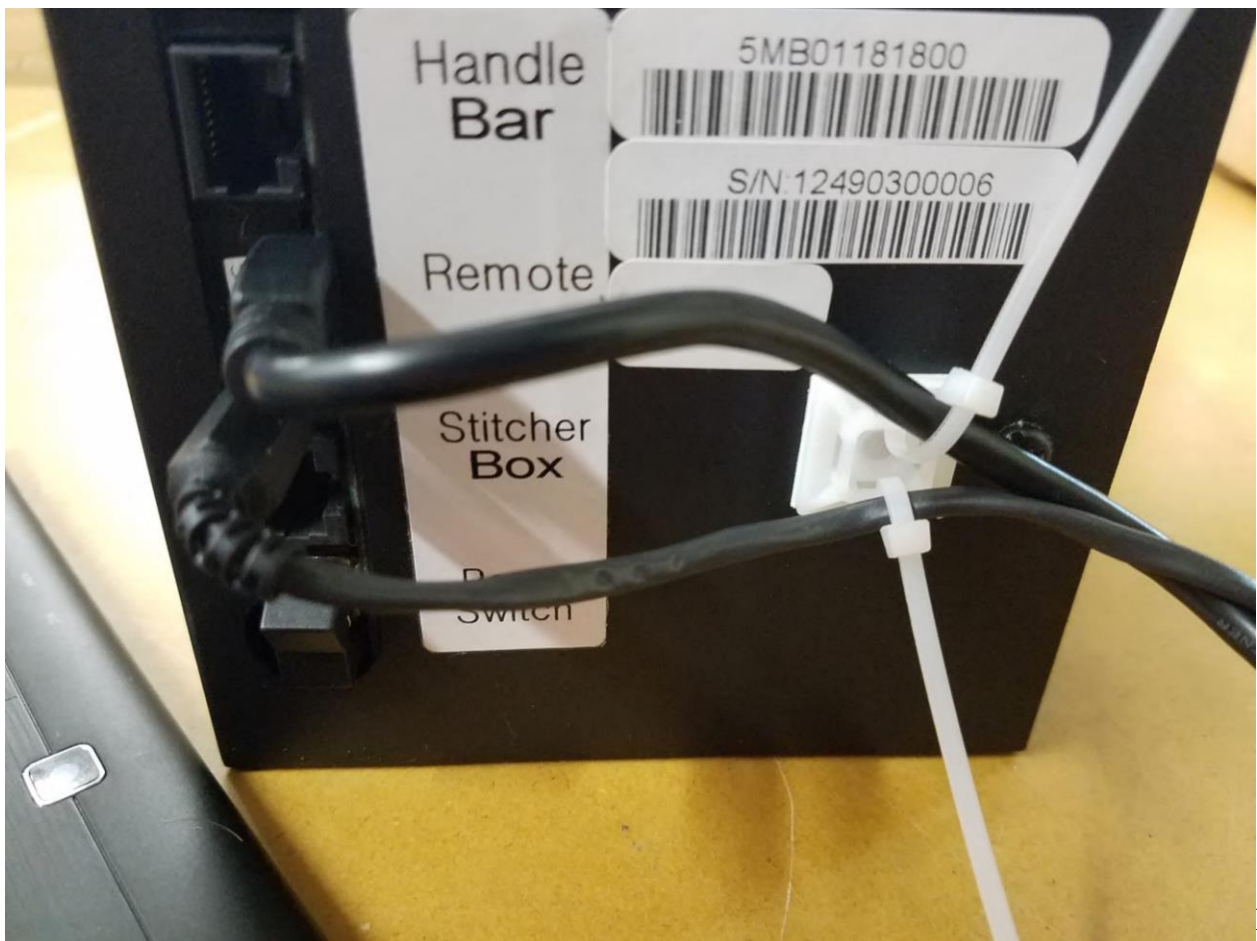

Find your Tablet's DC-IN and connect the other end of the power cable. Remember this is the smaller end of the power cable

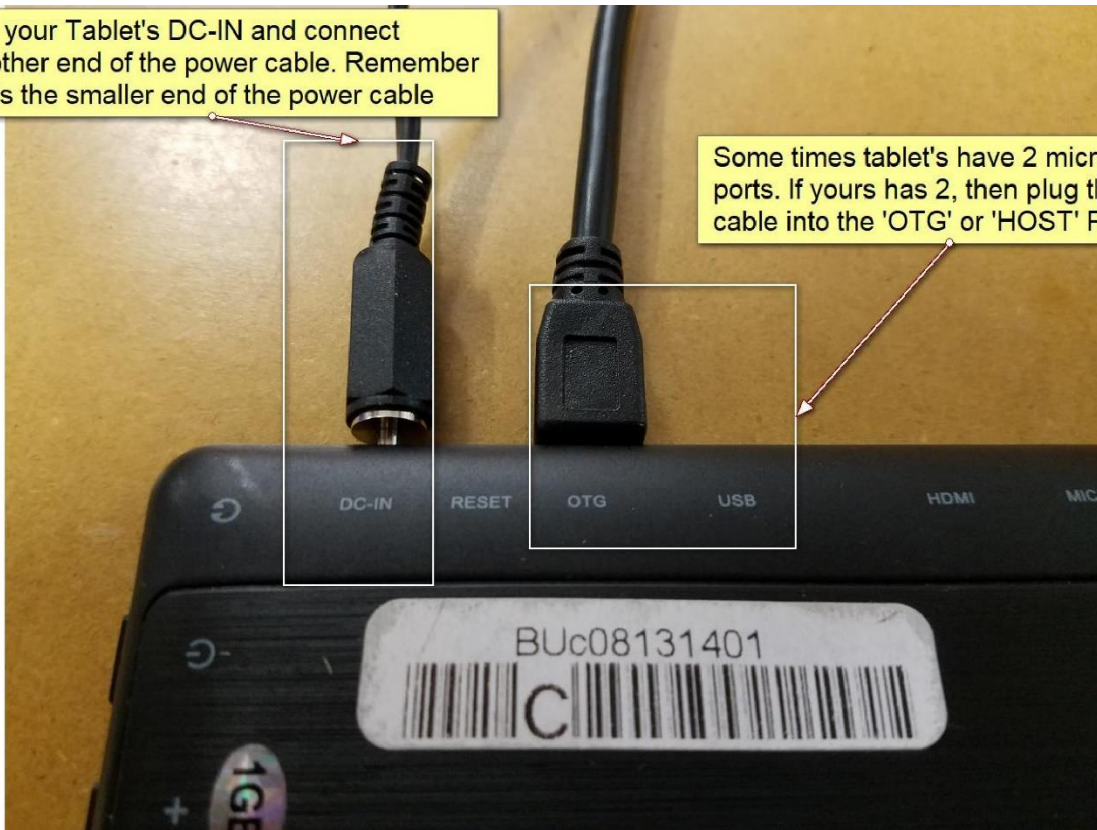

Some times tablet's have 2 micro-usb ports. If yours has 2, then plug the data cable into the 'OTG' or 'HOST' Port.

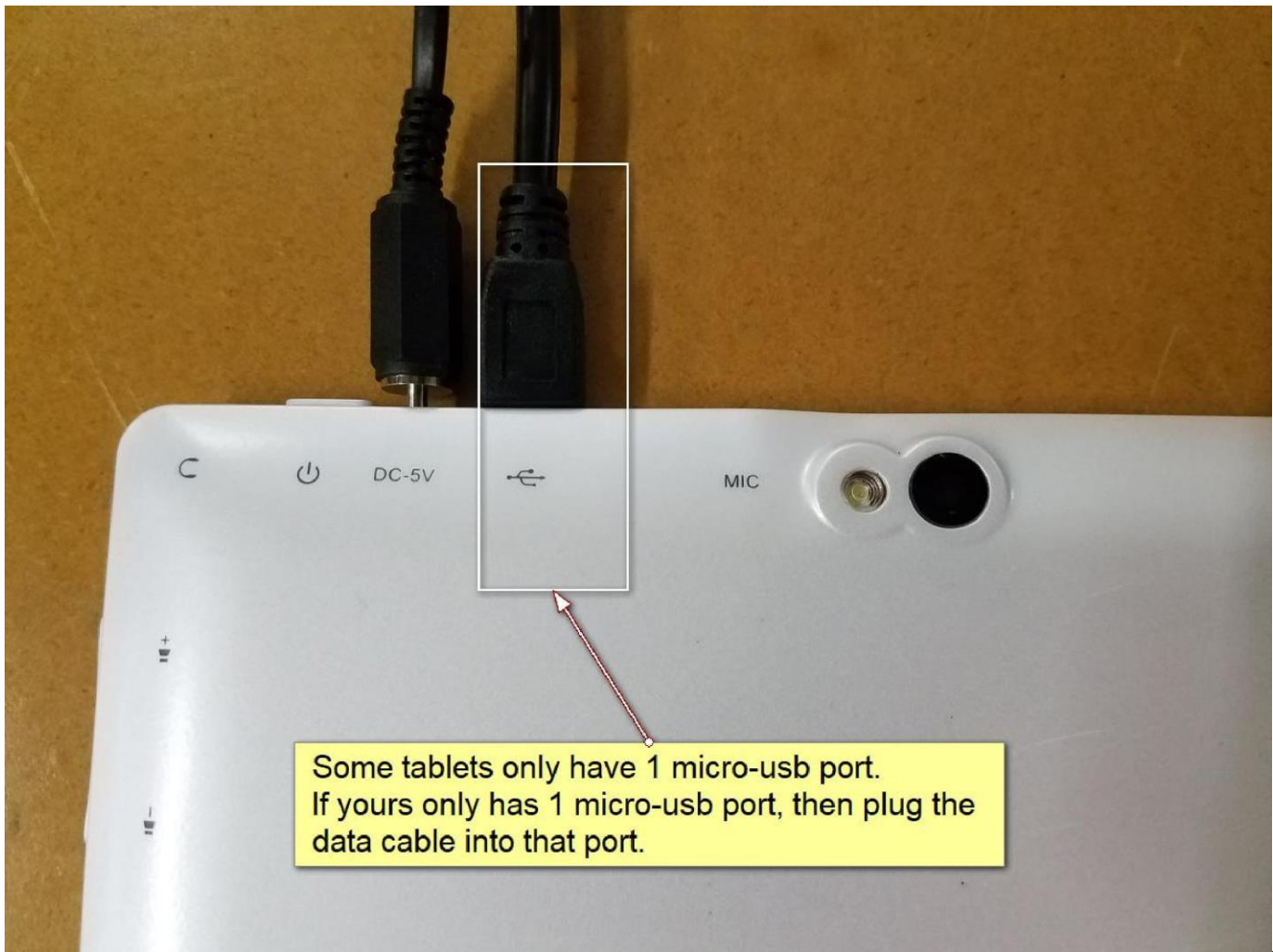

Some tablets only have 1 micro-usb port. If yours only has 1 micro-usb port, then plug the data cable into that port.

Power on Tablet

- 1 The tablet receives its charge from the machine. Power on the machine and let it charge the tablet for roughly ten minutes.

Press the power button on the top right corner of the tablet.

Power on robot, and/or machine, and then the tablet.



Unlock the Screen

- 1 Press and hold the lock icon, then drag your finger to the right lock icon and release.

Your display will now be unlocked

This step may not apply to all tablets.

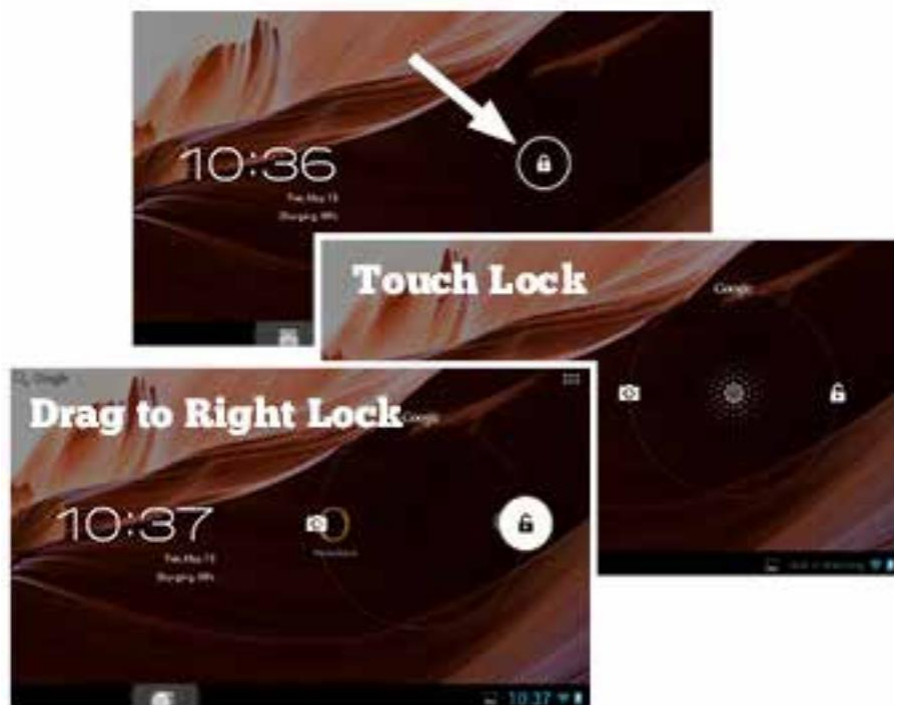

Open an App

1 Press the apps button (Looks like six little squares) This will be in either the top-right corner or in the middle near the bottom.

Select from the list the app that you wish to open.

Some apps may be found in the next window. Swipe the screen to the right to reveal more apps. Swipe left to return to first window.



Close an App

1 While on the home screen, press the recent apps icon.

A list of currently running apps will appear.

Press and hold the app you wish to close and slide off the screen. You will slide either up or down; or left or right depending on your display.

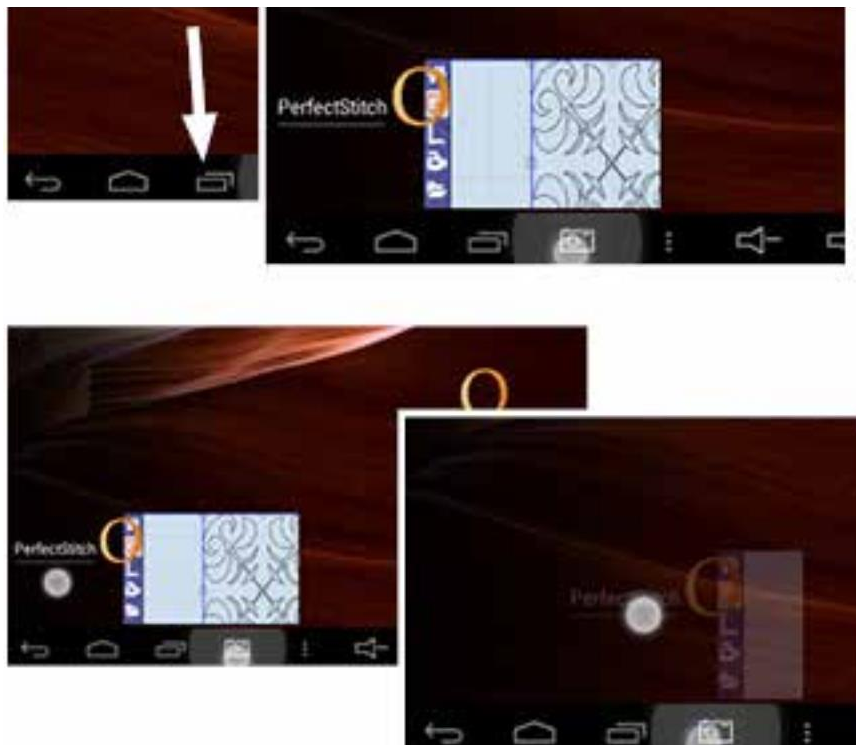

Update the Tablet

With a Robot Attached

1 Press the Settings button from the main menu.



2 Under the Updates tab select System Info.

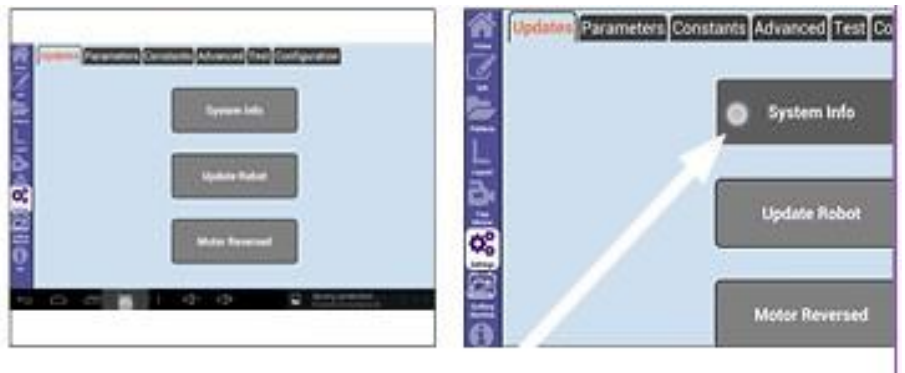

Press Check for Update. A button will appear that will prompt to download. Select this button to start the update.

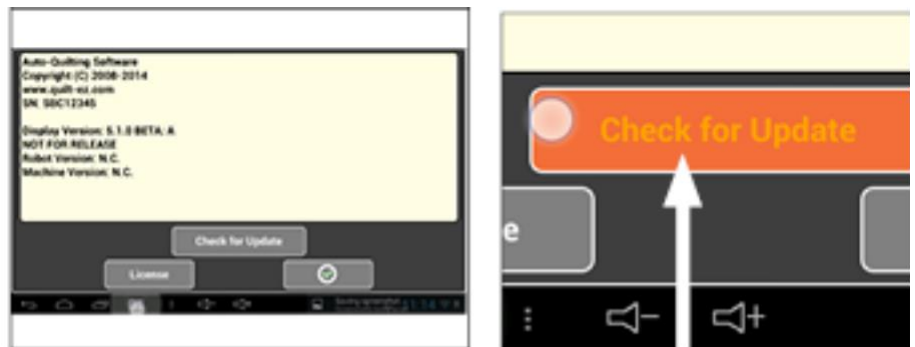

(If the display is already up to date you will receive the message indicated at the right.)



Without a Robot Attached

- 1 Select the folder icon from the top menu.

Then select Advanced in the bottom left.



- 2 Select System Information.



Press Check for Update. A button will appear that will prompt to download. Select this button to start the update.

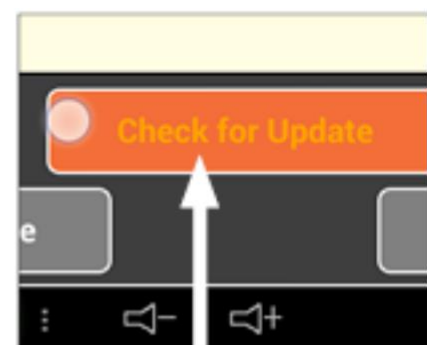

(If the display is already up to date you will receive the message indicated at the right.)



Power off Tablet

- 1 Power off robot and/or machine

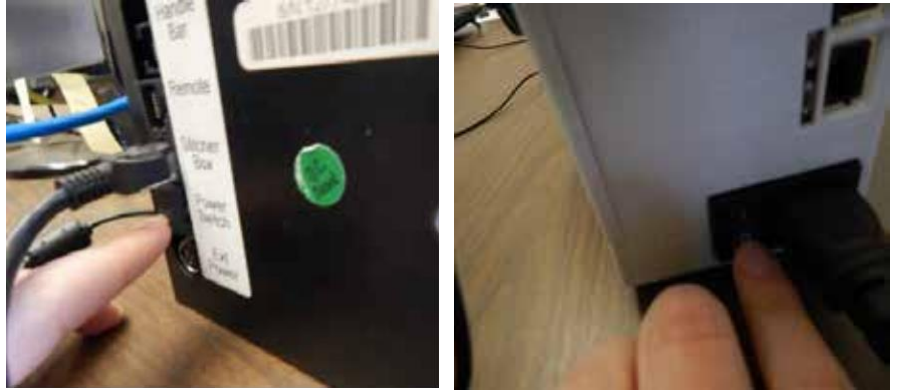

- 2 Hold the power button until the prompt to power off displays on the screen.



- 3 Select power off on the screen.

The tablet has to be manually powered off. Just because the screen is black does not mean that the tablet is off.

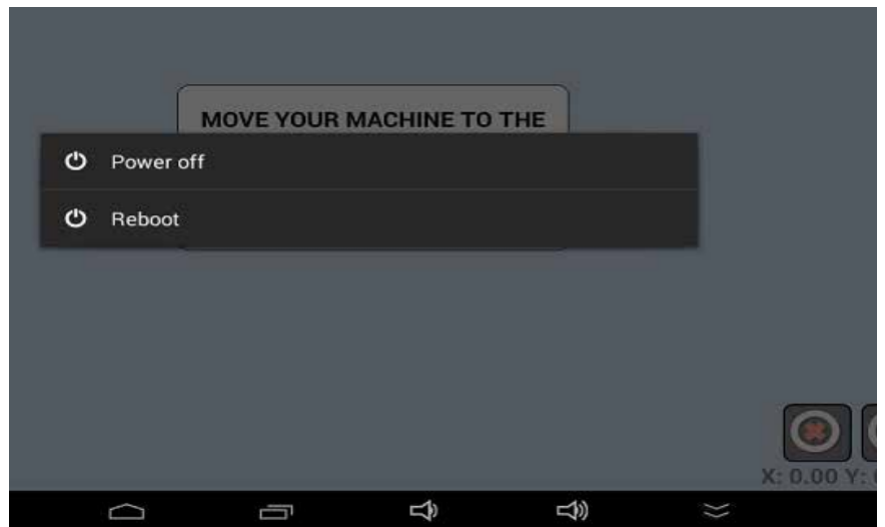

Troubleshooting

Symptom	Possible issue	Solution
I'm losing communication with my machine or robot	When the tablet is powered on/off several times in a row or too quickly it can cause communication issues.	Try to close the stitching application and reopen. See page 5. If that does not work close the application, and then power down the machine and/or robot. Ensure that all cables are secure, and then power everything back on.
Tablet won't turn on	The battery has died Tablet is stuck in boot up.	Try a hard reset. There are two ways to perform a hard reset. Hold down the power button for 25 seconds, then release On the top or back of the tablet is a pin sized reset button. Use a pin to press this button.
Tablet is frozen or stuck on a screen.	Tablet has gotten stuck on a screen or has stopped running	Try to select the Android home button and then reopen the program. If you cannot hit the Android home button try a hard reset. See how in solution for "Tablet won't turn on" step above.
Lights wont turn on from the tablet.	Fluorescent light setting is not activated on the tablet. A loose connection	Select the Folder icon at the top of the screen, select Advanced, and then select Fluorescent Lights from the bottom right. Contact Technical support for advanced troubleshooting steps.